

## Levelling feet

### Foot plastic, female thread

#### SPECIFICATION

##### Types

- Type **A**: without rubber underlay
- Type **G**: with rubber underlay

Foot: Plastic (Polyamide PA)

- glass fibre reinforced
- black, matt
- temperature resistant up to 100 °C

Female thread

Steel

- Tensile strength class 5.8
- zinc plated, blue passivated

Hexagon nut ISO 4032

Steel

zinc plated, blue passivated

Rubber underlay (NBR)

70 Shore A, black



#### INFORMATION

Levelling feet GN 343.3 are capable of withstanding high static loads through the use of a high density plastic material coupled with a design which distributes the load over a larger area.

Exceeding the static values specified in the table could lead to failure of the plastic component.

The above values have been arrived at by a series of load tests whereby a defined number of levelling feet were subjected to a vertical load over a defined period.

Under normal operating conditions side loading or angular loading is not uncommon and the load capacity would be considerably reduced which must be taken into consideration.

Levelling feet GN 343.3 are supplied assembled, but are removable.

#### TECHNICAL INFORMATION

- Elastomer characteristics (see page A32)
- Plastic characteristics (see page A2)

#### ON REQUEST

- ESD version (conductive plastic cap to avoid electrostatic charging)

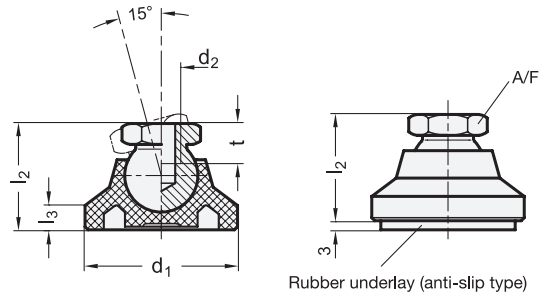

\* Complete with type index of the Levelling feet (A or G)

- A** without rubber underlay
- G** with rubber underlay

Rubber underlay (anti-slip type)

#### GN 343.3

Description	d1	d2	l2	l3	A/F	t min.	Static load in kN	⚖
GN 343.3-25-M6-*	25	M 6	18.5	4	12	9	5	19
GN 343.3-25-M8-*	25	M 8	18.5	4	12	9	5	13
GN 343.3-32-M8-*	32	M 8	22.5	5	12	9	7	15
GN 343.3-32-M10-*	32	M 10	22.5	5	15	10.5	7	22
GN 343.3-40-M10-*	40	M 10	25.5	6	15	10.5	10	26
GN 343.3-40-M12-*	40	M 12	25.5	6	17	11.5	10	33
GN 343.3-50-M10-*	50	M 10	27.5	7	15	10.5	10	48
GN 343.3-50-M12-*	50	M 12	27.5	7	17	11.5	10	39
GN 343.3-60-M12-*	60	M 12	35.5	8.5	17	11.5	14	96
GN 343.3-60-M16-*	60	M 16	35.5	8.5	24	16	14	81

Weight type A